

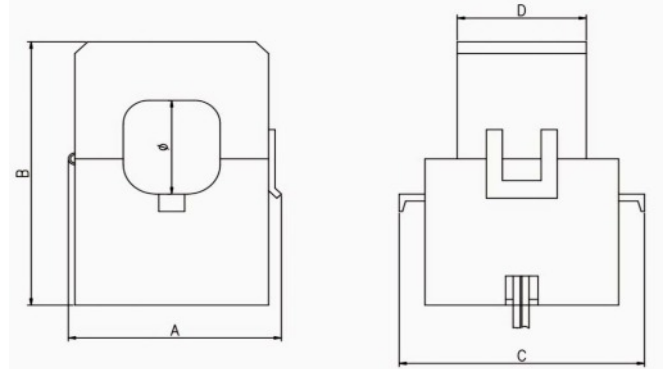

- Input: 100A to 600A AC
- Output:
  - AC: 5A or 1A AC,
  - DC: 4-20 mA, or 60 mV, or 10 V DC
- Accuracy: 0.5% ~ 1% of full scale from 10% to 150%
- Dielectric strength: 4kV
- Certification: IEC 60044-1, CE, UL and RoHS

Dimensions mm-ben

Model	A	B	C	D	Ø
TAH16	34	45	38	20	16
TAH24	51	66	43	23	24
TAH36	67	85	50	42	36
TAH50	93	120	70	28	50



Ip / output	Cl	TAH16	TAH24	TAH36	TAH50
100/5A	Class 1 & 0.5	TAH16-100/5A	TAH24-100/5A	TAH36-100/5A	TAH50-100/5A
100/1A	Class 1 & 0.5	TAH16-100/1A	TAH24-100/1A	TAH36-100/1A	TAH50-100/1A
150/5A	Class 1 & 0.5	TAH16-150/5A	TAH24-150/5A	TAH36-150/5A	TAH50-150/5A
150/1A	Class 1 & 0.5	TAH16-150/1A	TAH24-150/1A	TAH36-150/1A	TAH50-150/1A
200/5A	Class 1 & 0.5	TAH16-200/5A	TAH24-200/5A	TAH36-200/5A	TAH50-200/5A
200/1A	Class 1 & 0.5	TAH16-200/1A	TAH24-200/1A	TAH36-200/1A	TAH50-200/1A
250/5A	Class 1 & 0.5	TAH16-250/5A	TAH24-250/5A	TAH36-250/5A	TAH50-250/5A
250/1A	Class 1 & 0.5	TAH16-250/1A	TAH24-250/1A	TAH36-250/1A	TAH50-250/1A
300/5A	Class 1 & 0.5	TAH16-300/5A	TAH24-300/5A	TAH36-300/5A	TAH50-300/5A
300/1A	Class 1 & 0.5	TAH16-300/1A	TAH24-300/1A	TAH36-300/1A	TAH50-300/1A
400/5A	Class 1 & 0.5	TAH16-400/5A	TAH24-400/5A	TAH36-400/5A	TAH50-400/5A
400/1A	Class 1 & 0.5	TAH16-400/1A	TAH24-400/1A	TAH36-400/1A	TAH50-400/1A
500/5A	Class 1 & 0.5	TAH16-500/5A	TAH24-500/5A	TAH36-500/5A	TAH50-500/5A
500/1A	Class 1 & 0.5	TAH16-500/1A	TAH24-500/1A	TAH36-500/1A	TAH50-500/1A
600/5A	Class 1 & 0.5	TAH16-600/5A	TAH24-600/5A	TAH36-600/5A	TAH50-600/5A
600/1A	Class 1 & 0.5	TAH16-600/1A	TAH24-600/1A	TAH36-600/1A	TAH50-600/1A
100A/4-20 mA	Class 1 & 0.5	TAH16-100/4-20	TAH24-100/4-20	TAH36-100/4-20	TAH50-100/4-20
150A/4-20 mA	Class 1 & 0.5	TAH16-150/4-20	TAH24-150/4-20	TAH36-150/4-20	TAH50-150/4-20
200A/4-20 mA	Class 1 & 0.5	TAH16-200/4-20	TAH24-200/4-20	TAH36-200/4-20	TAH50-200/4-20
250A/4-20 mA	Class 1 & 0.5	TAH16-250/4-20	TAH24-250/4-20	TAH36-250/4-20	TAH50-250/4-20
300A/4-20 mA	Class 1 & 0.5	TAH16-300/4-20	TAH24-300/4-20	TAH36-300/4-20	TAH50-300/4-20
400A/4-20 mA	Class 1 & 0.5	TAH16-400/4-20	TAH24-400/4-20	TAH36-400/4-20	TAH50-400/4-20
500A/4-20 mA	Class 1 & 0.5	TAH16-500/4-20	TAH24-500/4-20	TAH36-500/4-20	TAH50-500/4-20
600A/4-20 mA	Class 1 & 0.5	TAH16-600/4-20	TAH24-600/4-20	TAH36-600/4-20	TAH50-600/4-20
100A/60mV	Class 1 & 0.5	TAH16-100/60mV	TAH24-100/60mV	TAH36-100/60mV	TAH50-100/60mV
150A/60mV	Class 1 & 0.5	TAH16-150/60mV	TAH24-150/60mV	TAH36-150/60mV	TAH50-150/60mV
200A/60mV	Class 1 & 0.5	TAH16-200/60mV	TAH24-200/60mV	TAH36-200/60mV	TAH50-200/60mV
250A/60mV	Class 1 & 0.5	TAH16-250/60mV	TAH24-250/60mV	TAH36-250/60mV	TAH50-250/60mV
300A/60mV	Class 1 & 0.5	TAH16-300/60mV	TAH24-300/60mV	TAH36-300/60mV	TAH50-300/60mV
400A/60mV	Class 1 & 0.5	TAH16-400/60mV	TAH24-400/60mV	TAH36-400/60mV	TAH50-400/60mV
500A/60mV	Class 1 & 0.5	TAH16-500/60mV	TAH24-500/60mV	TAH36-500/60mV	TAH50-500/60mV
600A/60mV	Class 1 & 0.5	TAH16-600/60mV	TAH24-600/60mV	TAH36-600/60mV	TAH50-600/60mV
100A/10V	Class 1 & 0.5	TAH16-100/10V	TAH24-100/10V	TAH36-100/10V	TAH50-100/10V
150A/10V	Class 1 & 0.5	TAH16-150/10V	TAH24-150/10V	TAH36-150/10V	TAH50-150/10V
200A/10V	Class 1 & 0.5	TAH16-200/10V	TAH24-200/10V	TAH36-200/10V	TAH50-200/10V
250A/10V	Class 1 & 0.5	TAH16-250/10V	TAH24-250/10V	TAH36-250/10V	TAH50-250/10V
300A/10V	Class 1 & 0.5	TAH16-300/10V	TAH24-300/10V	TAH36-300/10V	TAH50-300/10V
400A/10V	Class 1 & 0.5	TAH16-400/10V	TAH24-400/10V	TAH36-400/10V	TAH50-400/10V
500A/10V	Class 1 & 0.5	TAH16-500/10V	TAH24-500/10V	TAH36-500/10V	TAH50-500/10V
600A/10V	Class 1 & 0.5	TAH16-600/10V	TAH24-600/10V	TAH36-600/10V	TAH50-600/10V

**RAPAS kft**

1184 Budapest, Úllői út 315. Hungary  
Tel.: 36-20-992-0078

Internet: [www.aramvalto.com](http://www.aramvalto.com) e-mail: [rapaskft@rapas.hu](mailto:rapaskft@rapas.hu)